



# MINIMALIST FRAMES FOR MODERN INTERIORS



FROM THE MARKET LEADER!

# Sino frame for active leaf doors

The modern Sino frame is particularly characterized by its extremely narrow frame architrave of just 4mm.

The entrance area can be designed to be both exclusive and modest. When used in combination with concealed hinges and flush door leaves, the element is virtually invisible, perfectly matching the wall in a similar way to a concealed door.



- For flush closing door leaves
- For stud walls from a wall thickness of 100mm
- For brick walls from a wall thickness of 130mm
- Available with top-light, timber infill or glass infill
- As 1 part design
- Available in galvanized sheet steel (2.0mm)
- Available in stainless steel (1.5mm)
- Available with concealed hinges
- Design for all-glass doors possible

## Recommendations:

- Concealed hinges Simonswerk Tectus TE 541 3D FVZ
- Other hinge types on request

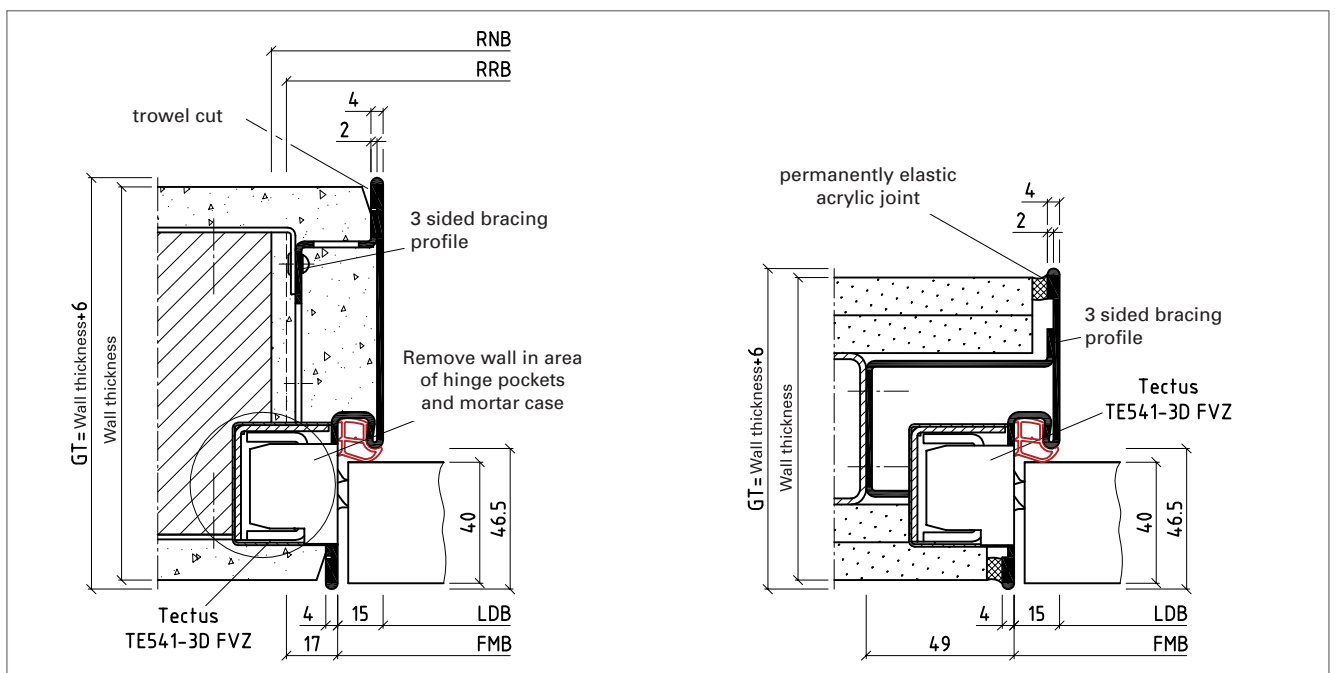

# LineaCompact Sino sliding door frame

The sliding door frame LineaCompact Sino is the ideal solution where space is limited, as the room required for opening an active leaf door is rendered unnecessary. An exclusive and yet inconspicuous combination of function and design is achieved through the extremely narrow frame architrave. The frame and the entry case are completely pre-mounted, allowing fast and easy installation. The door leaf runs inside the wall.



- Single and double door designs
- Also available for timber doors
- Easy door leaf mounting and adjustment
- Optional fitting of a DORMA CS 80 MAGNEO automatic operator

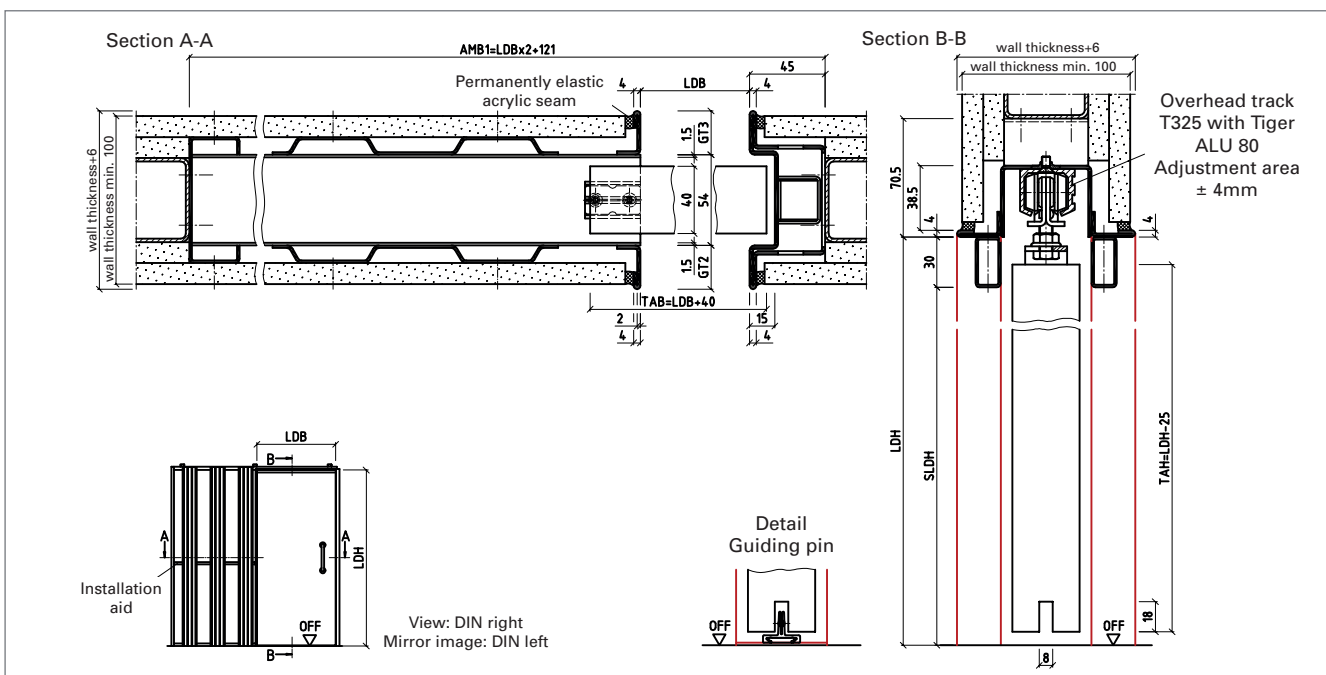

# LineaBox Standard

## sliding door system without frame

The sliding door case LineaBox Standard is particularly suitable for entrance areas where an unobtrusively designed through-way is required.

This non-visible element matches the wall design with its 'modest' style perfectly.

It can be universally used in combination with timber, aluminium or steel frames. To achieve an inconspicuous effect in the throughway, the LineaBox Standard can be designed with a frameless wall cladding.



- For wall thickness 100 or 125mm
- For 40mm timber door leaves
- For 8 or 10mm glass door leaves
- Without foundation bedding
- Incl. set of screws for single and double panelling

Head Office

**BOS GmbH Best Of Steel**  
Lütkenfelde 4

D-48282 Emsdetten

Jana Schievelkamp  
Tel.: +49 2572 203703  
E-Mail: [js@BestOfSteel.de](mailto:js@BestOfSteel.de)



UK Sales Management  
Matthew Jones  
BOS GmbH Best Of Steel  
12 Greencoates

GB-Hertford SG13 8AA

Tel.: +44 (0) 758 465 5828  
E-Mail: [mj@BestOfSteel.co.uk](mailto:mj@BestOfSteel.co.uk)